

# Regional Transportation & Training Center





# Logistics & Transportation Booming

These areas play to [DeKalb] county's strengths, such as an existing base of companies in **advanced manufacturing and logistics along the I-20 corridor**. "We're really going to be really intentional about how we attract these sorts of companies or industries to DeKalb County over the next five years."

**Dorian DeBarr, Interim Director at Decide DeKalb**

**GeorgiaTrend**



# Logistics Jobs By the Numbers...

**1 out of every 14** is related to the logistics industry

- 7% of all Georgia jobs
- 6% of Georgia's total output/sales (\$60.7B)
- 6% of Georgia's GDP (\$33.5B)
- 6% of Georgia Department of Revenue's FY2018 general fund receipts (\$1.3B)
- \$1.4B in tax revenue for local governments

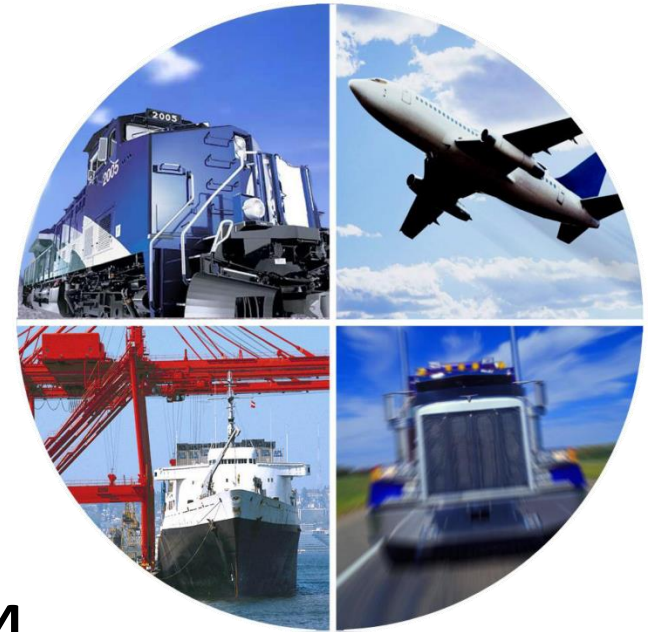

**Directly employed: 181,245** people in 15,794 establishments in Georgia. (79% private; 21% gov't)



# Project Highlights

- **28,000 square foot** Regional Transportation Training Center (RTTC) on **Marbut Road** located in Stonecrest, Georgia (largest in Georgia)
- Instrumental in producing **high-demand, skilled workers** for the transportation industry, notably **commercial truck drivers, logistics and distribution workers**
- **Ecosystem** specifically designed to encourage growth, excellence and collaboration
  - Credit and non-credit offerings
  - Governmental presence on site (i.e. economic development agencies)
  - Incubator space in support of transportation start-ups





# Where Are We Now?

- Submitted as **Capital Outlay** project to the Technical College System of Georgia
  - Requested \$4.9M for design and construction; \$817,822 for fixtures, furnishings, and equipment
  - College to secure \$4,000,000 in additional funding
- Collaborate with legislative delegation to secure remaining funds



# Estimated Project Cost Summary: **\$11.2M**

## State of Georgia

\$4,952,730 for Construction of One-Story Facility

\$817,822 for fixtures, furnishings, and equipment

## DeKalb County Board of Commissioners

**\$4,000,000 - REQUESTED**

## GPTC & Partners

\$1,500,000 for state-of-the-art equipment and faculty (Subject matter experts)



# RTTC High Bay Space – Back View



# RTTC Full Side View







# RTTC Classroom Layout

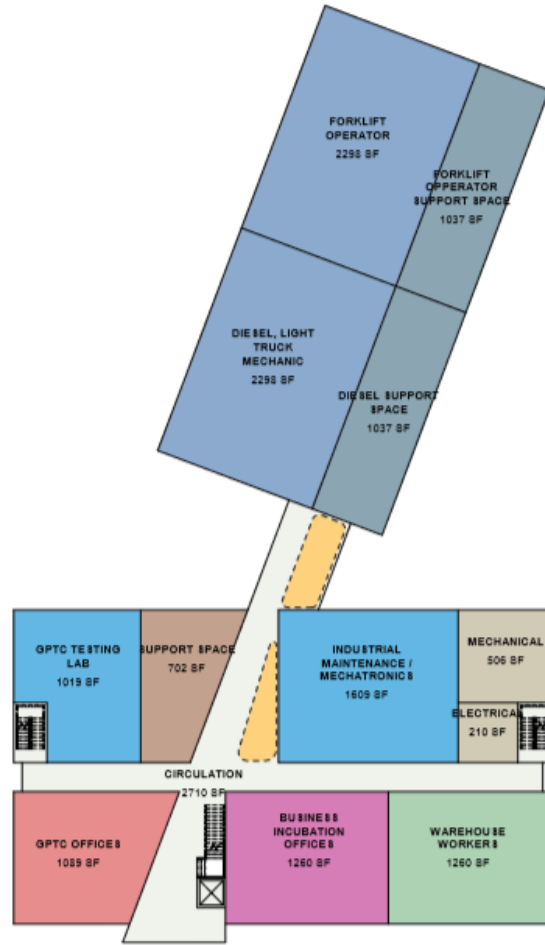

FIRST FLOOR - 17036 SF

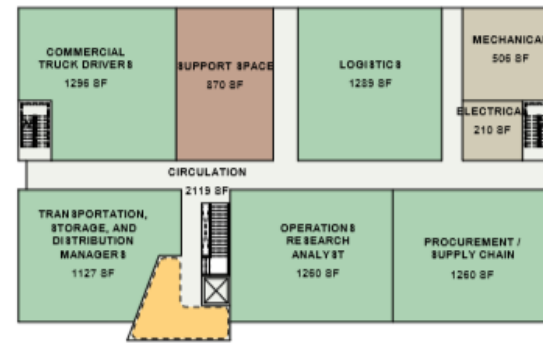

SECOND FLOOR - 9960 SF



## OCCUPANCY LEGEND

- CIRCULATION
- SUPPORT SPACE
- HIGH BAY SPACE
- HIGH BAY SUPPORT SPACE
- LAB / CLASSROOM
- CLASSROOM
- INCUBATION OFFICES
- OFFICES
- MECH / ELEC
- STUDENT BREAKOUT SPACE

TOTAL AREA - 26996 SF

# Site Layout

